

rineck
• Werkzeugtechnik



Metric

• Metric Shrink fit chucks

**DIN-SK50 69871-AD
Shrink Tools**

TOOLS ARE OUR PASSION  MADE IN GERMANY





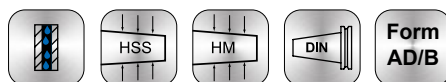
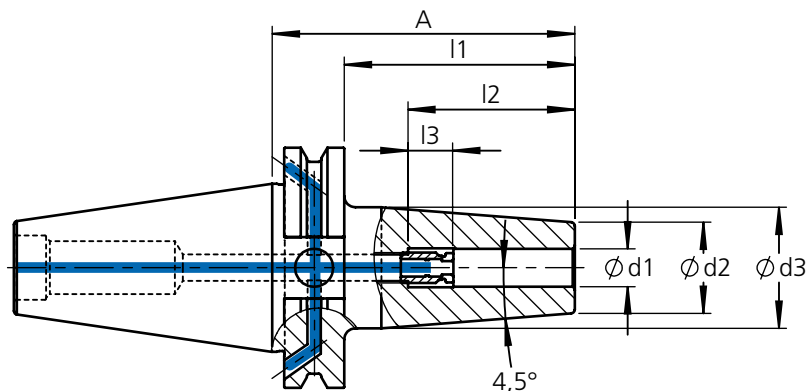

Shrink fit chuck SK50 DIN 69871 AD/B, standard execution 4,5° incl. length adjusting screw

Mandrin de frettage SK50 DIN 69871 AD/B, exécution 4,5°, vis de réglage axial inclus



69871

Bestell-Nr. order number No.	SK	Ø d1	Ø d2	Ø d3	A	l1	l2	l3		
985 - SK5020A80	SK50	20	33	42	80	60,9	52	10	948-006	G6,3/10.000
985 - SK5020A120	SK50	20	33	42	120	100,9	52	10	948-006	
985 - SK5020A160	SK50	20	33	42	160	140,9	52	10	948-006	
985 - SK5020A160-150	SK50	20	33	42	160	140,9	150	-	-	
985 - SK5020A200	SK50	20	33	42	200	180,9	52	10	948-006	
985 - SK5025A100	SK50	25	44	52	100	80,9	58	10	948-006	
985 - SK5025A120	SK50	25	44	52	120	100,9	58	10	948-006	
985 - SK5025A160	SK50	25	44	52	160	140,9	58	10	948-006	
985 - SK5025A160-150	SK50	25	44	52	160	140,9	150	-	-	
985 - SK5025A200	SK50	25	44	52	200	180,9	58	10	948-006	
985 - SK5032A100	SK50	32	44	52	100	80,9	62	10	948-006	
985 - SK5032A120	SK50	32	44	52	120	100,9	62	10	948-006	
985 - SK5032A160	SK50	32	44	52	160	140,9	62	10	948-006	
985 - SK5032A160-150	SK50	32	44	52	160	140,9	150	-	-	



www.rineck.de

rineck

• Werkzeugtechnik



TYSON TOOL®

TYSON TOOL COMPANY LIMITED
75 Ormont Drive, Toronto, ON. M9L-2S3
Tel: (416) 746-3688 -- Fax: (416) 746-5415
www.tysontool.com -- sales@tysontool.com

Available From