

# TXP75 \*75° SHELL MILL CUTTER

- Specifically designed to use the popular 222.79.400 insert and utilizes the opposing unused corners
- 100° corners offer strong cutting edges & maximum depth of cut
- High machining rates in semi-finishing and rough-milling operations

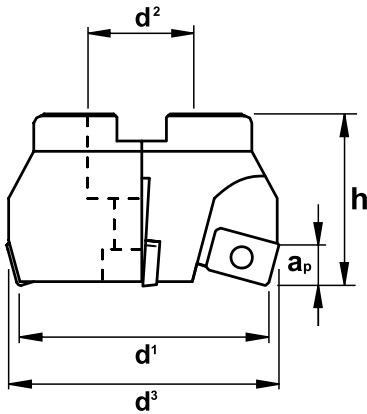

| $d^1$  | DESIGNATION | $d^2$ | $d^3$ | Depth of Cut $a_p$ | $h$  | Flutes |
|--|-------------|-------|-------|--------------------|------|--------|
| INSERT:  |             |       |       | 222.79.400         |      |        |
| 2.50   | TXP75-2500  | 1.000 | 2.60  | .275               | 2.00 | 4      |
| 4.00   | TXP75-4000  | 1.250 | 4.10  | .275               | 2.00 | 6      |
| Spare Parts: Torx® Insert Screw #214.80.388    Torx® Wrench #214.80.824 (S/D) or #214.80.012 (F/T) |             |       |       |                    |      |        |

\* not designed to use 222.79.500/510 series inserts

## WIDIA INSERTS FOR TXP75 MILLING CUTTERS

| WIDIA INSERT | DESIGNATION | DIMENSIONS |      |      |     |       | COATED |        |       |       |       |       | UNCOATED |       |     |     | CERMET |     |        |  |
|--------------|-------------|------------|------|------|-----|-------|--------|--------|-------|-------|-------|-------|----------|-------|-----|-----|--------|-----|--------|--|
|              |             | l          | s    | r    | d   | $d_1$ | TN7525 | TN7535 | TN25M | TPC25 | TPC35 | TN450 | TN5515   | HK15M | TTM | TTR | THM    | THR | TTI-25 |  |
|              | 222.79.400  | .635       | 3/16 | 3/64 | 3/8 | .173  | ●      | ●      | ●     | ●     | ●     | ●     | ●        | ●     | ●   |     |        |     |        |  |

# TYSON TOOL™

TYSON TOOL COMPANY LIMITED  
 75 ORMONT DRIVE, TORONTO, ONTARIO, M9L-2S3  
 TEL: (416) 746-3688 ~~ FAX: (416) 746-5415  
 INTERNET: www.tysonstool.com ~~ E-MAIL: sales@tysonstool.com

Available from: