

TSN45

High Shear Milling Cutters

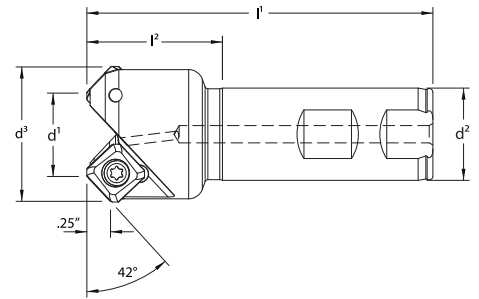

End Mills for High Metal Removal

Designation	d ¹	d ²	d ³	l ¹	l ²	Flutes	Insert	Insert Screw	Wrench
TSN45-1000	1.000	1.000	1.54	3.75	1.47	2	SNKT-1205 SNMT-1205 XNKT-1205	214.80.072	214.80.994 (S/D) 214.80.076 (F/T)
TSN45-1250	1.250	1.250	1.79	4.00	1.72	3			
TSN45-1500	1.500	1.250	2.04	4.00	1.72	4			
TSN45-2000EM	2.000	1.250	2.52	4.00	1.72	4			

Remember to use COPASLIP® anti-seize compound on all insert screws

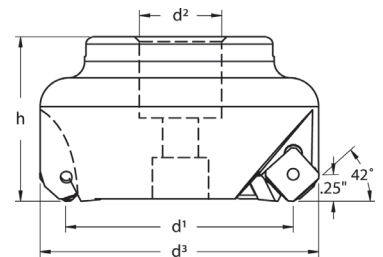

Face Mills for High Metal Removal

Designation	d ¹	d ²	d ³	h	Flutes	lbs.	Insert	Insert Screw	Wrench
TSN45-2000	2.000	.750	2.52	2.00	4	1.45	SNKT-1205 SNMT-1205 XNKT-1205	214.80.073	214.80.994 (S/D) 214.80.076 (F/T)
TSN45-2500	2.500	1.000	3.02	2.00	5	2.20			
TSN45-3000	3.000	1.000	3.56	2.00	6	3.00			
TSN45-4000	4.000	1.250	4.58	2.00	7	3.70			
TSN45-5000	5.000	1.500	5.52	2.00	8	5.75			
TSN45-6000	6.000	1.500	6.52	2.00	10	8.65			
TSN45-8000*	8.000	2.500	8.52	2.50	12	17.45			

* Cutter supplied with 4 holes on a 4" bolt circle

Remember to use COPASLIP® anti-seize compound on all insert screws



SN_T



XNKT

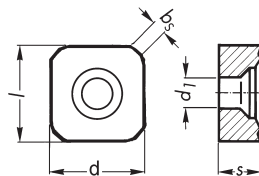

TSN45 Inserts

Designation	l	s	r	d	d ¹	bs	TSN45 Inserts														
							TN7525	TN6525	TN7535	TN6540	TN450	TN5515	TN6510	TN6520	TN2510	TTM	TTR	THM	THR	THM-U	TTI-25
SNKT-1205 AZER-20	.500	7/32	--	1/2	.217	.061	●	●	●	●	●	●	●	●	●	●	●	●	●	●	●
SNKT-1205 AZR-21	.500	7/32	--	1/2	.217	.061	●	●	●	●	●	●	●	●	●	●	●	●	●	●	●
SNKT-1205 AZR-31	.500	7/32	--	1/2	.217	.061	●	●	●	●	●	●	●	●	●	●	●	●	●	●	●
SNMT-1205 AZR-31	.500	7/32	--	1/2	.217	.061	●	●	●	●	●	●	●	●	●	●	●	●	●	●	●
XNKT-1205 AZER-11	.500	7/32	--	1/2	.217	.315	●	●	●	●	●	●	●	●	●	●	●	●	●	●	●
XNKT-1205 AZTR-12	.500	7/32	--	1/2	.217	.315	●	●	●	●	●	●	●	●	●	●	●	●	●	●	●